

SONANCE

BEYOND SOUND

## DESIGNED TO DISAPPEAR

Technology should disappear into architecture...this simple philosophy continues to inspire everything we do. Our hidden audio solutions deliver an even, balanced sound experience that is nothing short of magical, blending into any style, installation, or budget.

## AUTHENTIC PARTNERSHIP

Every day at our home base in San Clemente, CA, you will find passionate, immensely knowledgeable people forging some of the strongest relationships in our industry. From our customer-centric culture to our not-to-be-missed Studio Seminars, we aim to define what authentic partnership looks like. Connecting our strategy and products to your company, we help unlock the most value possible for your business. [Our team is your team.](#)

## A HERITAGE OF INNOVATION

The history of our independently-owned company is rooted in a deep knowledge of our customers and construction. From award-winning audio solutions to our unique TRUFIG mounting technology to our IPORT solutions that hold, charge, protect tablets, customers rely on our culture of creativity to continue to push the boundaries of technology and design.

## WE BELIEVE SPEAKERS SHOULD BLEND IN WITH THE DESIGN OF YOUR SPACE...

Audio is very much an integral part of the overall design of a space. When consideration is taken during the conceptual phase, the audio design can be a purposeful and elegant addition to a room while providing stunning audio to enhance the activities of everyday life. By paying attention to the architectural elements in a room, we often take cues from the size, shape, and trim of the lighting fixtures in the ceiling when considering a great speaker layout. The expansive Sonance finish options help to prompt the question, "How Do You Want Your Sound to Look?".

Lights in a ceiling are often selected to achieve suitable illumination for even coverage and to visually complement the design of the space. In order to achieve a harmony between lights and speakers, it makes sense for them to have a similar appearance. You can suit every aesthetic by selecting speakers that are the same shape, size, and installation profile as the lighting.

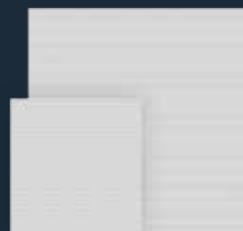
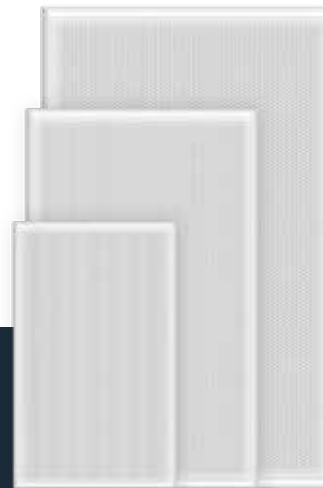

Sonance offers an extensive breadth of sizes, shapes, and finishes to elegantly complement the design elements of any space.



## ...AND BE COMFORTABLE TO LISTEN TO.

Music is a simple yet powerful element that enhances our day-to-day activities. We believe that audio should provide a comfortable listening environment by fidelity, output and proper coverage. Just as a great lighting plan provides even, balanced coverage of light, a great speaker layout should provide even, balanced coverage of sound. The result is an enveloping sound experience that allows for comfortable conversation anywhere in the room.



SONANCE

DISTRIBUTED

AUDIO

## TRADITIONAL COVERAGE

Only two speakers in a room often results in uneven volume throughout the space; too loud under the speakers and too quiet away from them. Similarly, if there are only two lights in a room, there would be problems with hot spots where some areas are too bright and other areas are too dim.

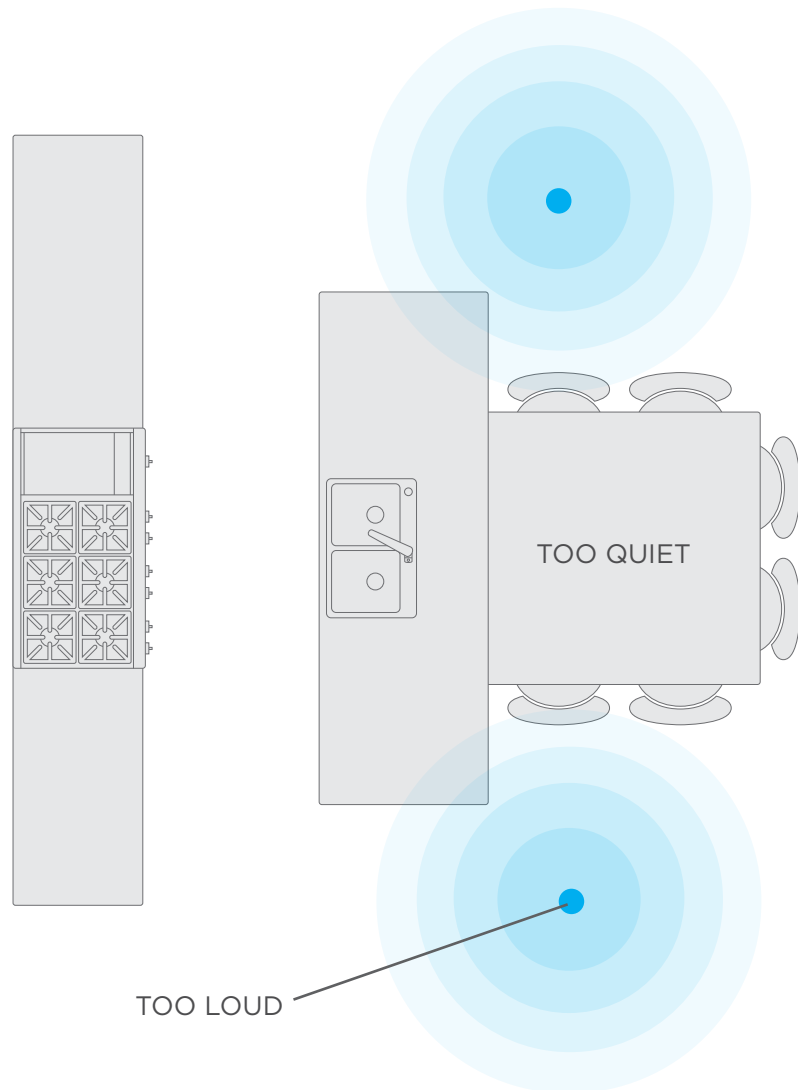

## EVEN, BALANCED COVERAGE

By designing a system of multiple speakers, hidden subwoofers and DSP amplification, sound is evenly distributed throughout the space.

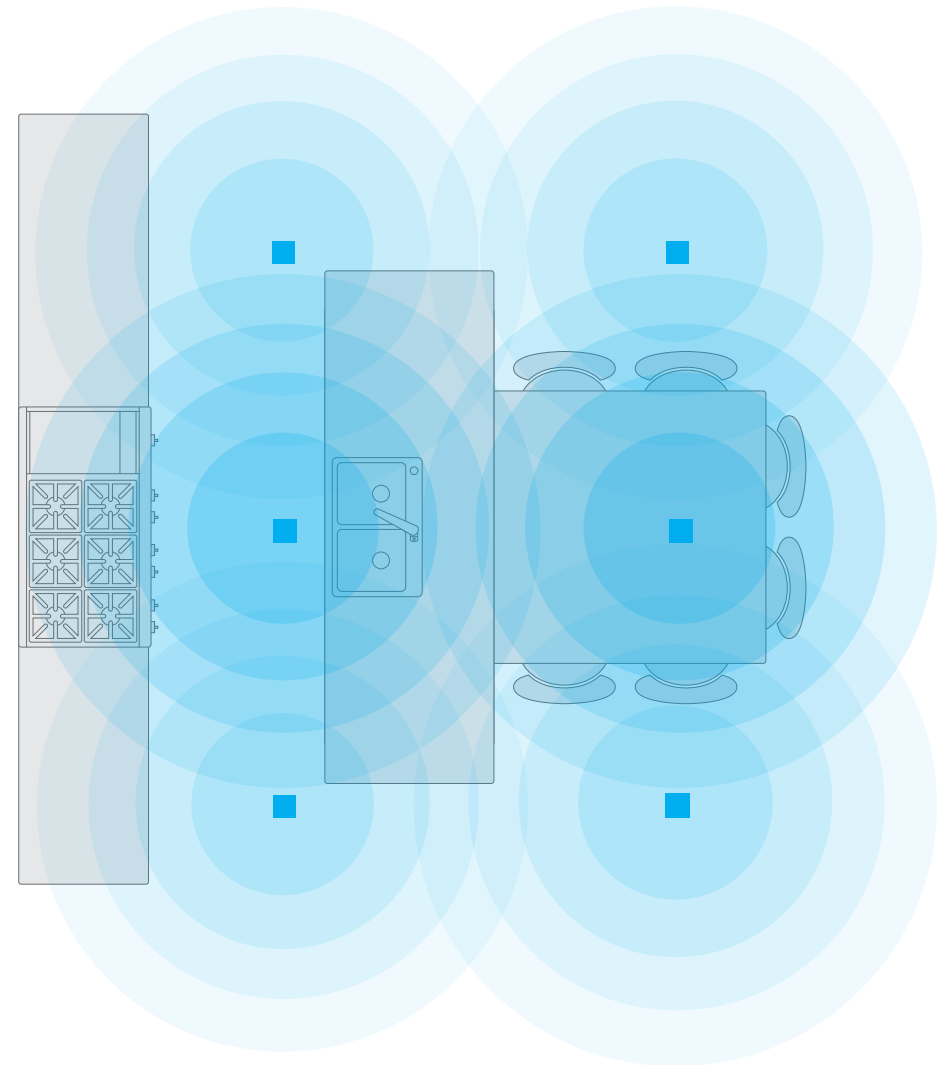



# A BETTER APPROACH TO HOME AUDIO

Sonance audio solutions can scale to meet the need of any space, from the open concept design of a great room to the intimate setting of a smaller bedroom or study.

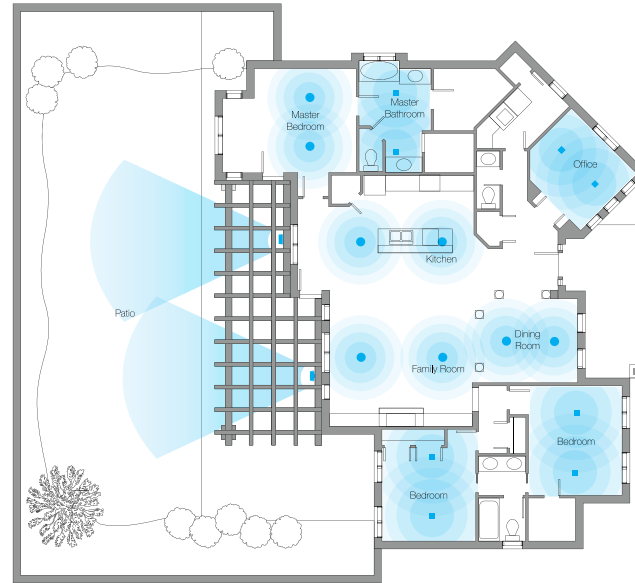

## TRADITIONAL COVERAGE

Uneven audio levels will compromise the mood in the room, resulting in “hot spots”.

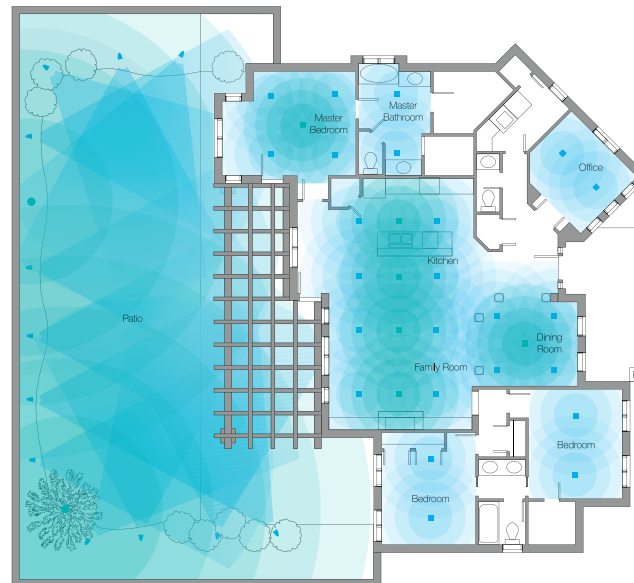

## EVEN, BALANCED COVERAGE

Everyone enjoys the perfect audio level, no matter where they are in the room.





# INVISIBLE SERIES

## SEE NOTHING

Sonance Invisible Series is the ultimate expression in architectural audio. Installed into the wall or ceiling and then finished over with the surrounding surface, Invisible Series speakers deliver ambient music that emanates throughout the space, seemingly coming from nowhere.



TRUFIG®

Sonance Invisible Series speakers and woofers are finished using TRUFIG mounting technology, a standardized custom installation method that has revolutionized the industry, saving integrators time and money by making the process predictable, reliable, and repeatable.

# PERFORMANCE AND DESIGN

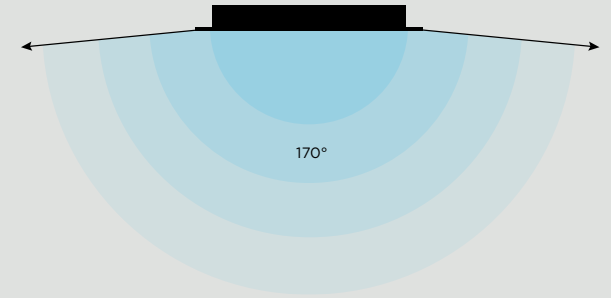
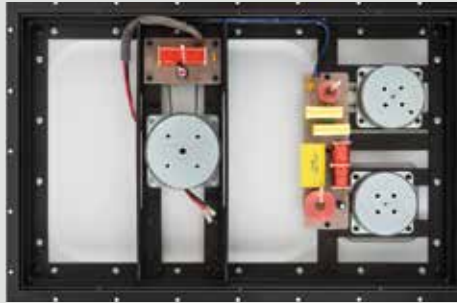
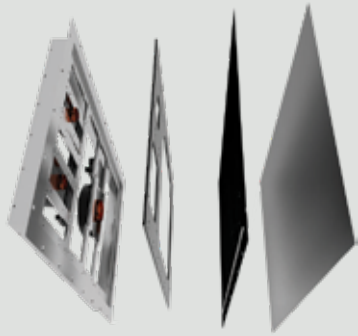

## STATE-OF-THE-ART DESIGN AND CONSTRUCTION

Sonance Invisible Series speakers feature a high-quality extruded aluminum chassis and injection molded polypropylene diagram for many years of reliable service and peace of mind.

## SUPERIOR SOUND

Sonance Invisible Series speakers reproduce full range audio, including crystal clear treble, natural midrange and deep smooth bass response. The result is best-in-class sonic performance that sets the benchmark for the Invisible Speaker category.

## WIDE DISPERSION

Sonance Invisible Series features a best-in-class 170° of dispersion, which means the sound is spread out wider from the speaker, delivering even volume levels and better sound quality throughout the entire space.

## SPEAKERS



IS2

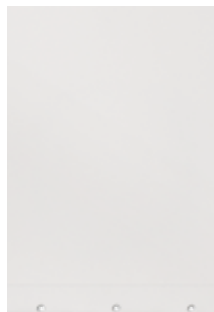

IS4

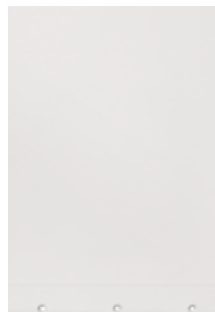

IS4 SST



IS4 C

### SMALL 2-WAY SPEAKER: IS2

Dimensions (WxHxD): 16 3/32" x 12 3/32" x 2"

### LARGE 3-WAY SPEAKERS: IS4 | IS4 SST | IS4 C

Dimensions (WxHxD): 16 1/8" x 24 1/8" x 3 11/16"

## WOOFER



ISW

### ISW

Dimensions (WxHxD): 16 1/8" x 24 1/8" x 2"

## CUSTOM PARTS



IS2 Small Space Saver



IS2 Small Enclosure



IS4, IS4 SST, and ISW Large Space Saver



IS4, IS4 SST, ISW Large Enclosure

# ARCHITECTURAL SERIES

## STUNNINGLY SIMPLE

Sonance Architectural Series products provide the ultimate blend of high performance and the premium aesthetic of our signature TRUFIG finish. The completely flush and bezel-less grilles disappear into the surrounding ceiling surface while the state-of-the-art driver materials and cutting-edge design elevate the listening experience.



Architectural Series mounting platforms use TRUFIG mounting technology to provide precision alignment with light fixtures and other room elements. The result is completely flush and the highest quality finish for drywall, plaster, wood and other solid surfaces preserving the design integrity of the space.

## DISCREET OPENING



AS38RS



Round Grille



Square Grille

### AS38RS

Dimensions (DiaxD): 3 7/8" x 3 13/16"

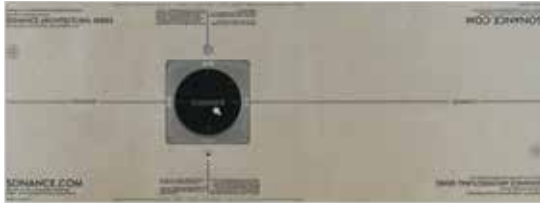

Discreet Gypsum Mounting Platform Round

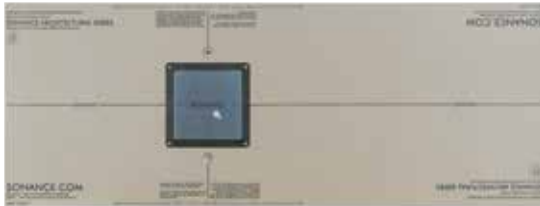

Discreet Gypsum Mounting Platform Square

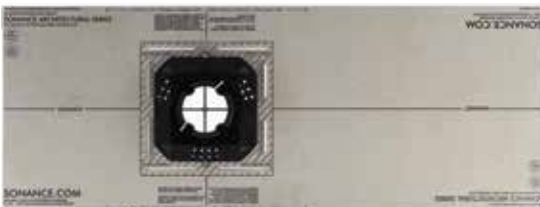

Discreet Solid Surface Mounting Platform SQ & R

### DISCREET GYPSUM MOUNTING PLATFORM

5/8" Square or Round | 1/2" Square or Round

### DISCREET SOLID SURFACE MOUNTING PLATFORM

Square and Round

Dimensions (WxHxD): 12" x 31 7/8" x 1 15/32"

## MEDIUM



AS68RS



Round Grille



Square Grille

### AS68RS

Dimensions (DiaxD): 8" x 5 3/16"



Medium Gypsum Mounting Platform Round



Medium Gypsum Mounting Platform Square



Medium Solid Surface Mounting Platform SQ & R

### MEDIUM GYPSUM MOUNTING PLATFORM

5/8" Square or Round | 1/2" Square or Round

### MEDIUM SOLID SURFACE MOUNTING PLATFORM

Square and Round

Dimensions (WxHxD): 16 3/8" x 30 13/32" x 3 13/16"

## BANDPASS SUBWOOFERS

Requires DSP 2-150 MKII or DSP 8-130 MKII amplification.



BPS8



ASBPC6RS



Round Grille



Square Grille

### BPS8 SUBWOOFER

Dimensions (HxWxD): 9 1/4" x 12 5/16" x 24"

Accessories: ASBPC6RS

Medium 1/2" or 5/8" Gypsum MP SQ or R

Medium Solid Surface MP SQ & R



BPS6 TL



ASBPC3RS TL



Round Grille



Square Grille



Square or Round Discreet Gypsum Mounting Platform TL for in-wall applications and shallow depth construction.



Thin-line Bandpass Slot Connector



### BPS6 TL SUBWOOFER

Dimensions (HxWxD): 39 3/8" x 11" x 3 3/8"

Accessories: ASBPC3RS TL

5/8" or 1/2" Gypsum MP SQ or R TL

Thin-line Bandpass Slot Connector



BPS6



ASBPC3RS



Round Grille



Square Grille

### BPS6 SUBWOOFER

Dimensions (HxWxD): 7 7/8" x 11 15/16" x 15 3/4"

Accessories: ASBPC3RS

Discreet 1/2" or 5/8" Gypsum MP SQ or R

Discreet Solid Surface MP SQ & R

Thin-line Bandpass Slot Connector



Thin-line Bandpass Slot Connector



# VISUAL PERFORMANCE

## SOLUTIONS FOR ALL

Sonance Visual Performance speakers and subwoofers set the industry standard for the visual finish of in-wall and in-ceiling speakers with our award-winning low-profile grille that is paintable to blend into the wall or ceiling surface. With three shapes and four sizes, several performance levels and a range of specialty application speakers, any space or application can have a consistent finish throughout.

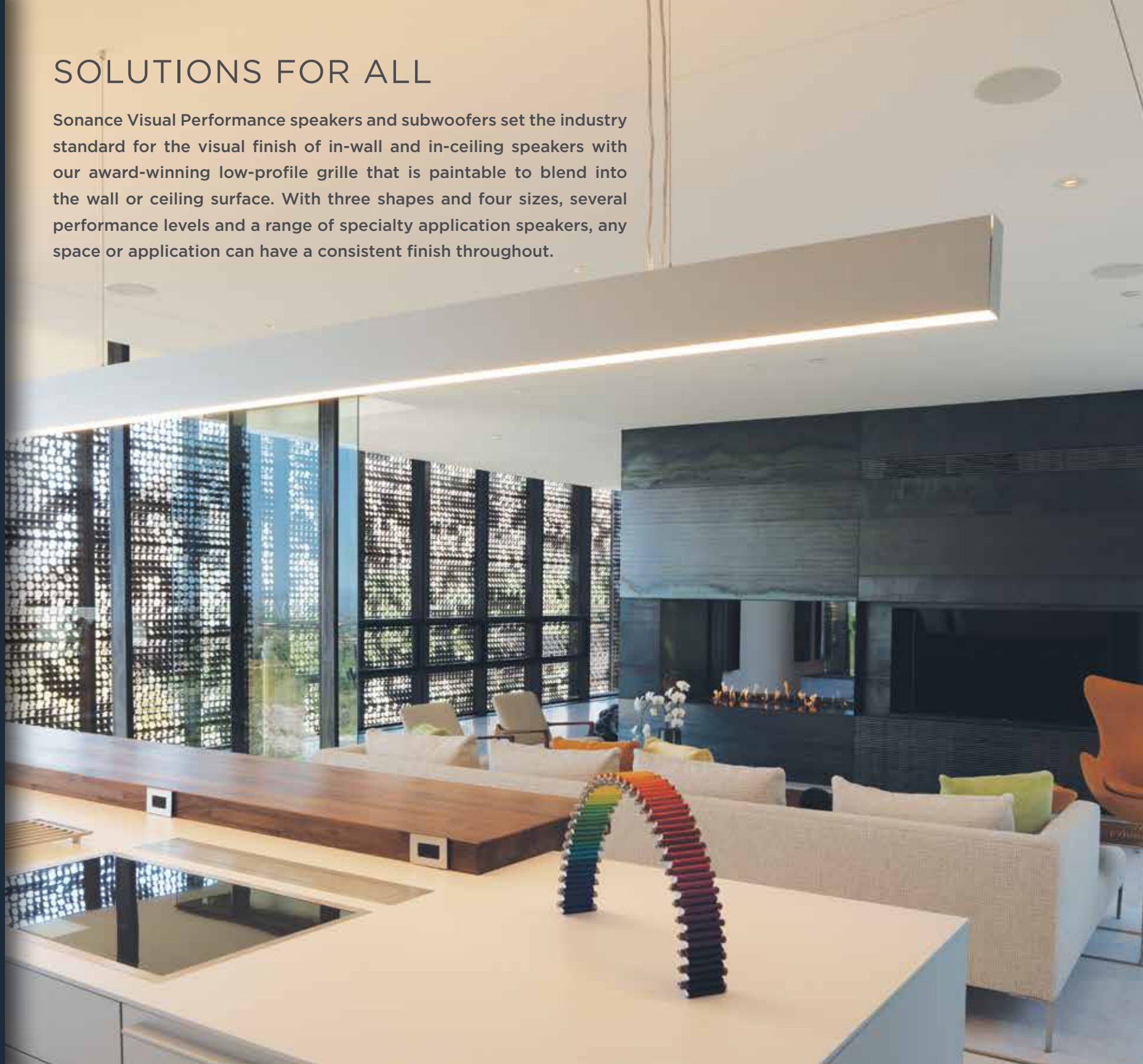

## PERFORMANCE LEVELS

Sonance Visual Performance Series speakers deliver renowned Sonance audio quality in five performance levels. Constructed from state-of-the-art materials that are extremely rigid and lightweight, Sonance Visual Performance Series speakers enable music to reproduce accurately and with precise detail. With multiple performance levels, there is a Sonance speaker for every ear and every budget.



### LEVEL 4

**WOOFER:** Textured Polypropylene cone, rubber surround

**TWEETER:** Powder coated Aluminum dome, Ferrofluid cooled, pivoting



### LEVEL 0

**WOOFER:** Polypropylene cone, rubber surround

**MID RANGE:** Polypropylene cone, rubber surround

**TWEETER:** Cloth dome, Ferrofluid cooled



### LEVEL 2

**WOOFER:** Textured Polypropylene cone, rubber surround

**MID RANGE:** Textured Polypropylene cone, rubber surround

**TWEETER:** Cloth dome, Ferrofluid cooled, pivoting



### LEVEL 6

**WOOFER:** Kevlar/Nomex laminated cone, rubber surround

**MID RANGE:** Kevlar/Nomex laminated cone, rubber surround, pivoting

**TWEETER:** Powder coated Aluminum dome, Ferrofluid cooled, pivoting



### LEVEL 8

**WOOFER:** Carbon Fiber/Rohacell laminated cone, rubber surround, extended pole piece

**MID RANGE:** Carbon Fiber/Rohacell laminated cone, rubber surround, pivoting

**TWEETER:** Ceramic dome, Ferrofluid cooled, pivoting

## SPEAKER DENOTATION

Sonance speakers can be easily identified by their naming structure.

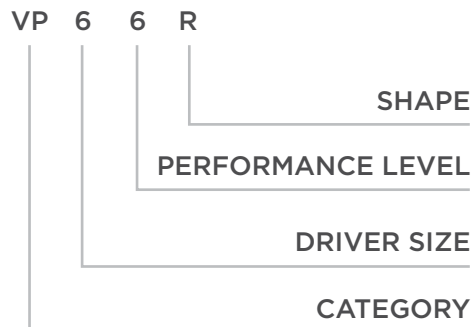

## SQUARE ADAPTER

Square grille adapter allows the flexibility to convert a round in-ceiling speaker to a square aesthetic without additional cutting into the surface.

## DIRECTIONAL WOOFERS AND TWEETERS

Independently pivoting woofers and tweeters allow for placement of speakers where they look the great with directionality for the best sonic performance.

## COLOR MATCHING

One-piece paintable grilles allow for a single-step painting process, ensuring a high-quality result and accurate color matching that allows them to disappear into the surrounding wall or ceiling.

## IN-WALL



VP48

VP46

VP42



VP68

VP66

VP62



VP88

VP86

VP82

**4" SPEAKERS:** VP48 | VP46 | VP42  
Dimensions (WxHxD): 5 9/16" x 8 7/8" x 3"

**6" SPEAKER:** VP68 | VP66 | VP62  
Dimensions (WxHxD): 8 3/8" x 12 1/4" x 3 1/2"

**8" SPEAKERS:** VP88 | VP86 | VP82  
Dimensions (WxHxD): 10" x 16" x 3 7/8"

## IN-CEILING

Square adapter optional

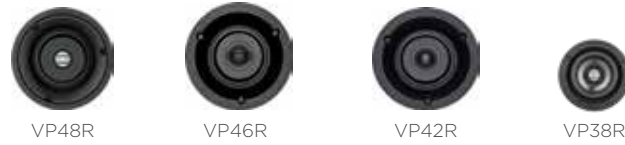

VP48R

VP46R

VP42R

VP38R



VP68R

VP66R

VP64R

VP62R

VP60R



VP88R

VP86R

VP82R

VP80R

**3" SPEAKER:** VP38R  
Dimensions (DiaxD): 4 5/16" x 3 7/8"

**4" SPEAKER:** VP48R | VP46R | VP42R  
Dimensions (DiaxD): 6 7/8" x 3 3/4"

**6" SPEAKERS:** VP68R | VP66R | VP64R | VP62R | VP60R  
Dimensions (DiaxD): 9 3/4" x 4 3/4"

**8" SPEAKERS:** VP88R | VP86R | VP82R | VP80R  
Dimensions (DiaxD): 11 5/8" x 6 1/16"

## IN-CEILING C SERIES

Square adapter optional



C6R

C6R SST

**6" SPEAKER:** C6R | C6R SST  
Dimensions (DiaxD): 9" x 3 3/4"

## SQUARE ADAPTERS

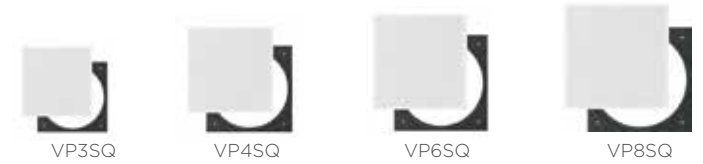

VP3SQ

VP4SQ

VP6SQ

VP8SQ

**VP3SQ**  
Dimensions (WxH): 4 29/32" x 4 29/32"

**VP4SQ**  
Dimensions (WxH): 7" x 7"

**VP6SQ**  
Dimensions (WxH): 9 7/8" x 9 7/8"

**VP8SQ**  
Dimensions (WxH): 11 3/4" x 11 3/4"

## THIN-LINE / ULTRA THIN-LINE



VP66R TL

VP62R TL

VP62R  
SST/SUR TL

VP52R UTL

VP66 TL

**IN-CEILING ROUND SPEAKERS:** VP66R TL | VP62R TL  
VP62R SST/SUR TL | VP52R UTL (Depth of 1 7/16")  
Dimensions (DiaxD): 9 3/4" x 3 5/32"

**IN-WALL RECTANGLE SPEAKER VP66 TL**  
Dimensions (WxHxD): 5 9/16" x 8 7/8" x 2 1/2"



## EXTREME

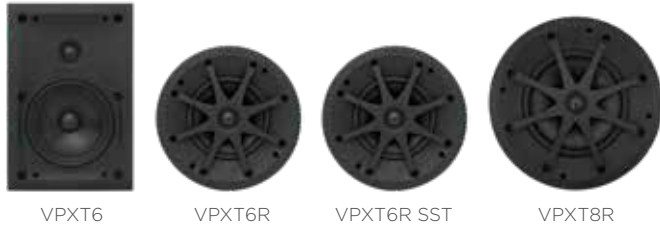

**IN-WALL RECTANGLE SPEAKER: VPXT6**  
Dimensions (WxHxD): 8 3/8" x 12 1/4" x 2 1/2"

**IN-CEILING ROUND SPEAKERS: VPXT6R | VPXT6R SST**  
Dimensions (DiaxD): 9 3/4" x 3 1/2"

**IN-CEILING ROUND SPEAKER: VPXT8R**  
Dimensions (DiaxD): 11 5/8" x 3 3/4"

## EXTREME SQUARE ADAPTERS



**VPXT6SQ**  
Dimensions (WxH): 4 29/32" x 4 29/32"

**VPXT8SQ**  
Dimensions (WxH): 11 7/8" x 11 7/8"

## LCR



**IN-WALL SPEAKERS: VP62 LCR | VP66 LCR**  
Dimensions (WxHxD): 5 9/16" x 8 7/8" x 3 9/16"

## SINGLE STEREO



**6" RECTANGLE SPEAKER: VP66 SST/SUR**  
Dimensions (HxWxD): 8 3/8" x 12 1/4" x 3 1/2"

**4" SPEAKER: VP46R SST/SUR**  
Dimensions (DiaxD): 6 7/8" x 3 3/4"

**6" SPEAKER: VP62R SST/SUR | VP66R SST/SUR**  
Dimensions (DiaxD): 9 3/4" x 4 3/4"

**8" SPEAKER: VP86R SST/SUR**  
Dimensions (DiaxD): 11 5/8" x 5 7/8"

## PRECONSTRUCTION ACCESSORIES



## SUBWOOFERS

Requires DSP 2-150 MKII or DSP 8-130 MKII amplification.



**SUBWOOFER: BPS8**  
Dimensions (HxWxD): 9 1/4" x 12 5/16" x 24"  
Required Accessory: VPBPC4R or VPBPC6R

**SUBWOOFER: BPS6 TL**  
Dimensions (HxWxD): 39 3/8" x 11" x 3 3/8"  
Required Accessory: VPBPC3R TL or VPBPC3R

**SUBWOOFER: BPS6**  
Dimensions (HxWxD): 7 7/8" x 11 15/16" x 15 3/4"  
Required Accessory: VPBPC3R



**SUBWOOFER: VPSUB**  
Dimensions (WxHxD): 15" x 15" x 3 7/8"

**WOOFER: VP85R W**  
Dimensions (DiaxD): 11 5/8" x 3 7/8"

**WOOFER: VP85 W**  
Dimensions (HxWxD): 16" x 10" x 3 7/8"

# AMPLIFIERS



## INDUSTRY-LEADING AMPLIFICATION

When it comes to reliable distributed audio, nobody has been doing it longer than Sonance. Building from the legacy of the original SonAmp 260, recognized as the industry's first distributed audio amplifier, Sonance Digital and DSP Amplifiers utilize cutting-edge technology to bring out the absolute best sonic performance from Sonance speakers.



## PERFECTLY TAILORED AUDIO PERFORMANCE

Every space is acoustically different. DSP amplifiers complete every system by offering digital signal processing to optimize the performance of Sonance systems and speakers and to help correct for a room's shape, size, and furnishings. This ensures audiophile clarity in every room.

## OUTSTANDING AUDIO IN ANY ENVIRONMENT

Sonance DSP amplifiers feature SonARC (Sonance Advanced Room Correction) built right in, providing hundreds of EQ presets designed specifically for Sonance speakers, available through simple pull-down menus. The presets enable effortless DSP without the need for outside hardware, software, and time. Additionally, should there be a need for further customization, SonARC provides a 10-band parametric EQ to optimize sonic performance in any space.



# ADAPTABLE AND FLEXIBLE

Whether a space is a new construction, remodel, large or small, DSP amplifiers are powerful and flexible to work with various combinations of Sonance speakers and subwoofers. Sonance also offers 70V/100V DSP amplifiers that can be set for 8 Ohm or 70V/100V applications, making them perfect for commercial applications as well as residential.



4  
CHANNELS

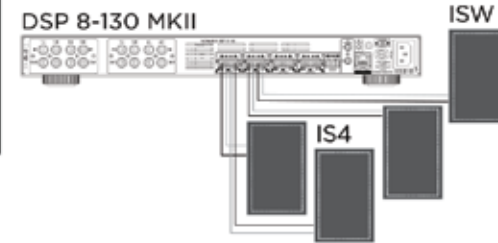

5  
CHANNELS

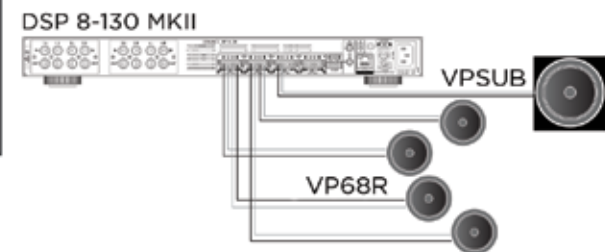

6  
CHANNELS

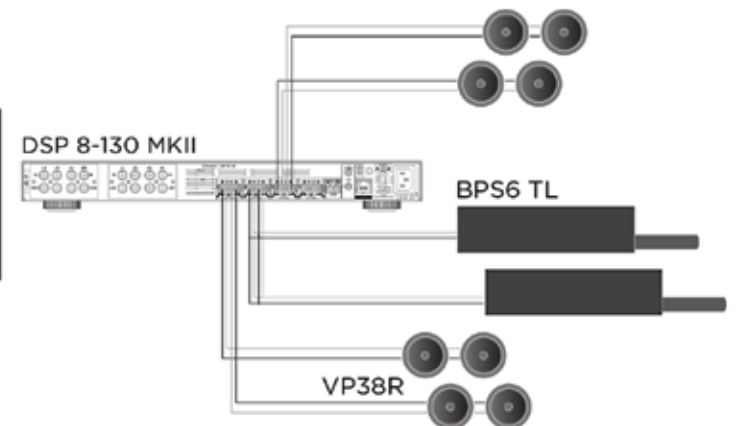

## DIGITAL AMPLIFIERS



2-100	Output Power per Channel: 100 W RMS (8 Ohms) 156 W RMS (4 Ohms), 325 W (bridged at 8 Ohms)
ASAP3D SE	Output Power per Channel: 25 W RMS (8 Ohms) 50 W RMS (4 Ohms)
12-50	Output Power per Channel: 50 W RMS (8 Ohms) 50 W RMS (4 Ohms), 100 W (bridged at 8 Ohms)

## DSP AMPLIFIERS WITH SONARC V2

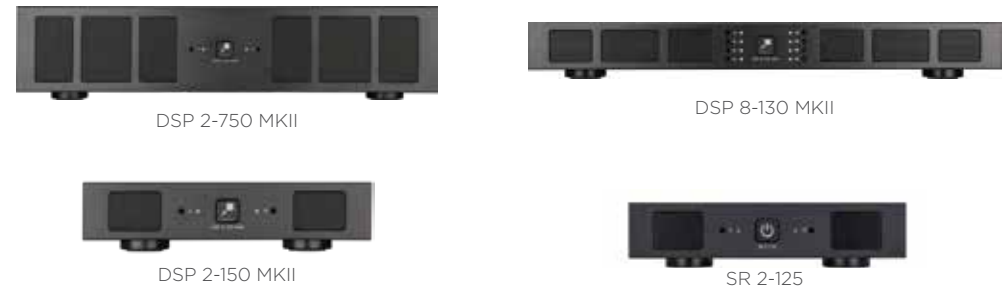

DSP 2-750 MKII	Output Power per Channel: 500 W RMS (8 Ohms) 750 W RMS (70V), 2000 W (bridged at 8 Ohms)
DSP 8-130 MKII	Output Power per Channel: 130 W RMS (8 Ohms) 145 W RMS (4 Ohms), 300 W (bridged at 8 Ohms)
DSP 2-150 MKII	Output Power per Channel: 150 W RMS (8 Ohms) 224 W RMS (4 Ohms), 473 W (bridged at 8 Ohms)
SR 2-125	Output Power per Channel: 125 W RMS (8 Ohms) 200 W RMS (4 Ohms)

## HIGH-RESOLUTION PLAYBACK

At the core of every Sonance DSP amplifier is a powerful 24 bit/96K DAC, capable of handling a full 4608 Kbps of audio data. Sonance DSP amplifiers enable listeners to enjoy the full clarity and output of whatever audio passes through, from MP3 to full high-resolution audio. Sonance DSP amplifiers prepare any audio system for what's next.



## DIGITAL INPUT MODULE & HYBRID INPUT MODULE

Sonance Input Modules are the ultimate enhancements to a Sonance DSP amplifier. These input cards enable a direct connection to a digital source ensuring the signal passes through to the 24 bit/96kHz capable DAC in the amplifier with the shortest signal path possible and at the highest performance level.

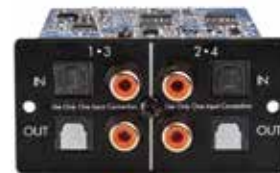

Digital Input Module



Hybrid Input Module

### DIM MODULE

Dimensions (WxHxD): 3" x 1 1/2" x 3 13/32"  
Depth with RCAs: 3 11/16"

### HIM MODULE

Dimensions (WxHxD): 3" x 1 1/2" x 3 13/32"  
Depth with RCAs: 3 11/16"

SONANCE

SURROUND

SOUND

# SURROUND SOUND APPLICATIONS

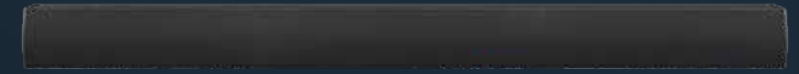

SB46-65



VP46R SST/SUR



D8

## CASUAL ENTERTAINMENT

With the understanding that not every space is intended to be used as a dedicated theater, Sonance offers an assortment of products to build a stunning surround experience in rooms with unique layouts and space limitations. Sonance surround sound products allow for a superbly immersive experience even in casual viewing and gathering areas.

# ULTIMATE EXPERIENCE

For spaces that demand the ultimate surround sound immersion, Sonance excels with a selection of dedicated speakers and high-performance subwoofers; fidelity, clarity, and output culminate in breathtaking saturation of all the audio content has to offer.



R2



R2SUR

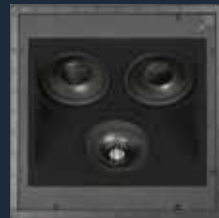

R1C



R1SURC



R12SUB



# REFERENCE

## REFERENCE SURROUND SOUND

Sonance understands the importance of proper fidelity and output for an astounding surround sound experience. Sonance Reference products are built to work in harmony to captivate the audience. Whether installed in a dedicated theater or a multi-media family room, Reference speakers and subwoofers bring the content close to life for a truly immersive experience.



## REFERENCE

Sonance takes entertainment to a whole new level with a range of purpose-built products that are specifically designed to bring out the best in television, movies, gaming and concerts. From living rooms to dedicated home theater spaces, the complete range of Sonance surround sound products delivers an intense and impactful experience to home entertainment.

## DESIGNED TO DISAPPEAR

Created for AV Designers building systems that require the best surround sound available with a look that fits the space aesthetically, Sonance Reference speakers provide truly incredible sound. Engineered for an amazing cinema experience in any room, Reference has options for in-wall, in-ceiling and cabinet speakers, and in-wall subwoofers.

## MIX AND MATCH

No two spaces are the same, which is why Reference speakers are designed to be mixed and matched to suit any room layout. The consistent drivers and crossover design allow for in-wall, in-ceiling or cabinet speakers to be combined without compromising the sonic performance of the system.

## IN-WALL



R2

R2SUR

IN-WALL SPEAKERS: R2 | R2SUR  
Dimensions (WxHxD): 8 7/8" x 34 7/8" x 3 7/8"



R1

R1SUR

IN-WALL SPEAKERS: R1 | R1SUR  
Dimensions (WxHxD): 8 7/8" x 21 3/4" x 3 7/8"

## IN-CEILING



R1C

R1SURC

IN-CEILING SPEAKERS: R1C | R1CSUR  
Dimensions (WxHxD): 13 25/32" x 13 25/32" x 7 9/16"

## REFERENCE LCR CABINET



R1CAB

LCR CABINET SPEAKER: R1CAB  
Dimensions (WxHxD): 7 1/2" x 22" x 9 1/16"

## REFERENCE IN-WALL SUBWOOFERS

Reference in-wall subwoofers execute the massive bass response of a large cabinet subwoofer without sacrificing floor space. The micro-trim grille provides a clean and discreet finish that can be painted to match the surrounding surface. Sonance Reference in-wall subwoofers utilize large neodymium magnets, dual inverted spiders, and a rigid laminated carbon fiber cone to achieve deep, impactful bass from a shallow design that can be installed into a standard 2x4 wall cavity.



## REFERENCE IN-WALL SUBWOOFERS



R10SUB



R12SUB



R10SUBENC



R12SUBENC

**10" SUBWOOFER: R10SUB**  
 Dimensions (WxHxD): 10 7/16" x 10 7/16" x 3 5/32"

**12" SUBWOOFER: R12SUB**  
 Dimensions (WxHxD): 12 3/8" x 12 3/8" x 3 5/32"

**10" ENCLOSURE: R10SUB ENC**  
 Dimensions (WxHxD): 14 1/4" x 47 1/4" x 3 7/16"

**12" ENCLOSURE: R12SUB ENC**  
 Dimensions (WxHxD): 14 1/4" x 70 7/8" x 3 7/16"

## REFERENCE IN-WALL SYSTEMS



R10SUBENC System



R12SUBENC System

**R10SUB ENC 10" SYSTEM**  
 (Includes 2 subwoofers, 2 enclosures, 1 DSP 2-150)  
 Dimensions (WxHxD): 14 1/4" x 47 1/4" x 3 7/16"

**R12SUB ENC 12" SYSTEM**  
 (Includes 2 subwoofers, 2 enclosures, 1 DSP 2-750)  
 Dimensions (WxHxD): 14 1/4" x 70 7/8" x 3 7/16"

# SUBWOOFERS

## CABINET SUBWOOFERS

Sonance cabinet subwoofers are each designed with an integrated amplifier and sealed amp plate, allowing for low frequency punch for even the biggest room, while the rear or bottom mounted controls provide quick access to adjust the subwoofer as needed. Each subwoofer also includes built-in wireless technology and SonARC app-based room correction, optimizing placement of the subwoofer anywhere in the room.

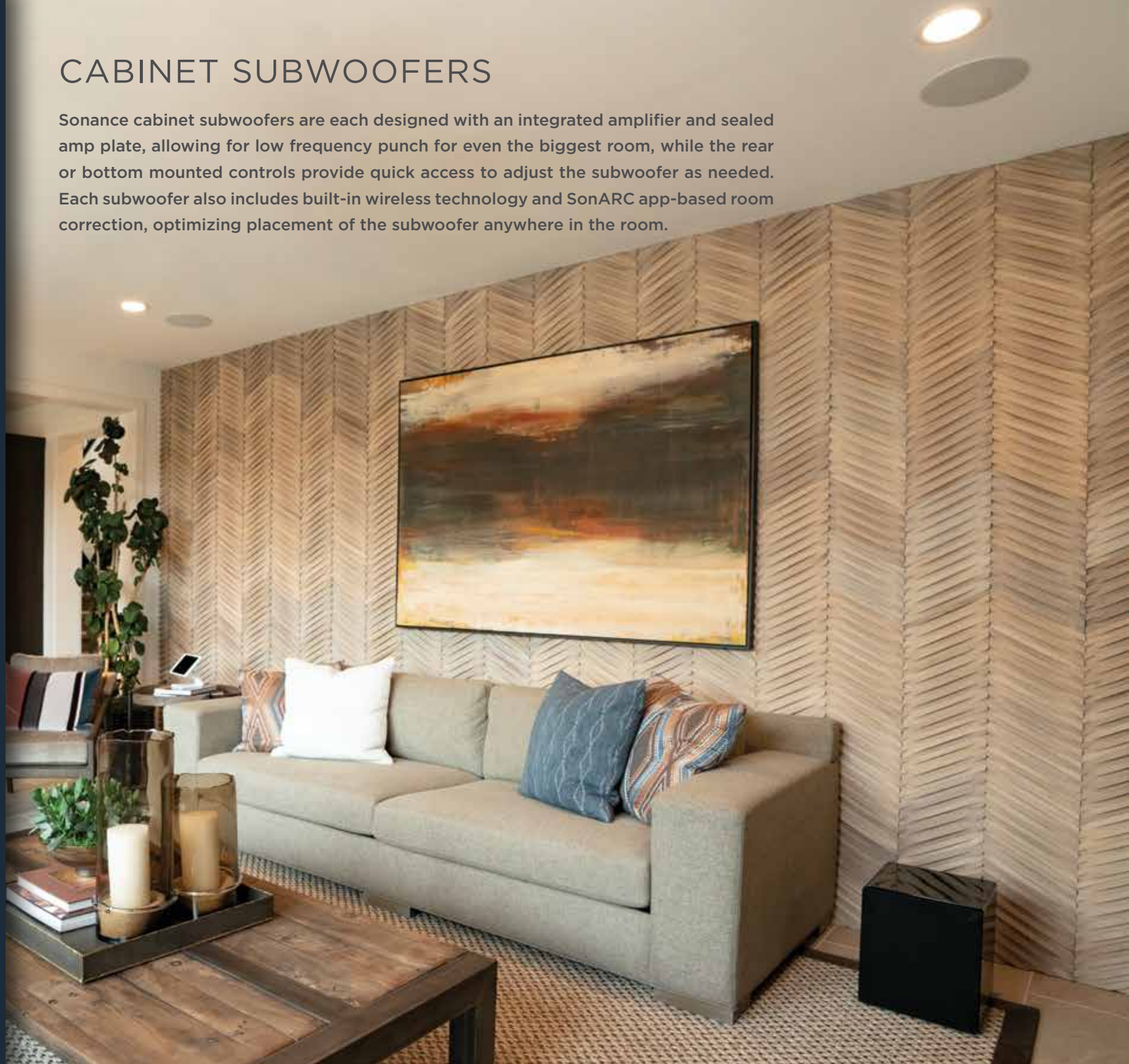

## IMPACT SUBWOOFERS

Sonance Impact subwoofers are constructed to deliver powerful, accurate, low-distortion bass in any room. Featuring a glass fiber woofer cone, a sealed amp plate, and a front facing ported design; Impact subwoofers are the perfect low end support for watching TV or movies, playing video games, or listening to music.

## ELEGANT AESTHETIC

Impact subwoofers feature a high gloss piano-black finish and black cloth speaker grille to deliver an elegant and minimalistic aesthetic. The cabinet dimensions have been kept to a minimum to reduce the visual impact in the room.

**SONARC™**  
for Subwoofers

## SONARC FOR SUBWOOFERS

The SONARC app allows you to instantly configure the Impact subwoofer for great playback with key adjustment at your fingertips. Let Sonance adjust the Impact subwoofer to the room with SonARC customization within the app.



## IMPACT CABINET SUBWOOFERS

Featuring SonARC V2



i8



i10



i12

### i8 CABINET SUBWOOFER

Dimensions (WxHxD): 12" x 14" x 12"

### i10 CABINET SUBWOOFER

Dimensions (WxHxD): 14" x 16" x 14"

### i12 CABINET SUBWOOFER

Dimensions (WxHxD): 16" x 18" x 16"

## WIRELESS TRANSMITTER



### WIRELESS TRANSMITTER

Dimensions (WxHxD): 1 3/16" x 3 1/8" x 2 1/2"

## D8 SUBWOOFER

The Sonance D8 subwoofer delivers remarkably powerful bass from an ultra-compact cabinet featuring two powerful opposing 8" square drivers. Paired with the optional wireless transmitter and SonARC DSP technology, the D8 placement becomes completely flexible allowing it to live virtually anywhere in the room.



SONARC™  
for Subwoofers

## D8 SUBWOOFER



**D8 SUBWOOFER**  
Dimensions (WxHxD): 7.5" x 7.5" x 9"  
Available in black and white  
Featuring SonARC V2

## TINY DESIGN, HUGE SOUND

The Sonance D8 subwoofer features two powerful vibration-canceling 8" square drivers, wireless connectivity and our SonARC for subwoofers DSP technology, all within a sleek ultra-compact cabinet.



## WIRELESS TRANSMITTER



**WIRELESS TRANSMITTER**  
Dimensions (WxHxD): 1 3/16" x 3 1/8" x 2 1/2"



# SOUNDBAR



## SOUNDBARS

Sonance soundbars offer a wide range of solutions that fit any flat panel display from 50" up to 85". Our fixed width soundbars provide a clean aesthetic while our adjustable width soundbars provide onsite adjustability, giving you the ability to perfectly match the width of any display. The minimalistic black perforated metal grille allows for a seamless aesthetic that complements modern display designs, while the true 3-way speaker configuration and state-of-the-art driver materials deliver best-in-class sonic performance, with clarity, wide sound stage, and natural playback.

## ADJUST TO MATCH YOUR DISPLAY

Sonance adjustable soundbars feature sliding end grilles that are adjusted without the use of tools. Simply loosen the thumbscrew on the back and slide the grille out to perfectly match the width of the display. It couldn't be easier.

## SEAMLESS GRILLE SOLUTIONS

Sonance soundbar combines proven Sonance adjustable soundbar performance with a sleek single-piece grille to perfectly match most large video displays with a seamless finish. With a soundbar to fit displays 55", 65", 75" and 85", Sonance soundbar ensures a custom look and finish every time with class-leading audio performance.

## TRUE 3-WAY DESIGN

Each of the three speaker chambers features a coaxial 1" powder-coated aluminum tweeter, a 4" laminated Kevlar and Nomex midrange, paired with dual 4 1/2" laminated Kevlar and Nomex woofers. This expertly engineered design delivers sound which is both natural and precise.

## SOUNDBAR



SB46-55

### SB46-55 SOUNDBAR

Dimensions (WxHxD): 48 5/16" x 5 9/32" x 2 9/16"



SB46-65

### SB46-65 SOUNDBAR

Dimensions (WxHxD): 56 29/32" x 5 9/32" x 2 9/16"



SB46-75

### SB46-75 SOUNDBAR

Dimensions (WxHxD): 66" x 5 9/32" x 2 9/16"



SB46-85

### SB46-85 SOUNDBAR

Dimensions (WxHxD): 75 1/4" x 5 9/32" x 2 9/16"

## ADJUSTABLE-WIDTH SOUNDBAR



SB46M Soundbar

### SB46M SOUNDBAR

Dimensions (Adj. WxHxD): 43 7/8" - 59 5/8" x 5 9/32" x 2 9/16"



SB46L Soundbar

### SB46L SOUNDBAR

Dimensions (Adj. WxHxD): 61 1/2" - 77 5/16" x 5 9/32" x 2 9/16"

## SUGGESTED SPEAKER PAIRING



VP46R SST/SUR

**4" SPEAKER: VP46R SST/SUR**  
Dimensions (DiaxD): 6 7/8" x 3 3/4"

## SUGGESTED SUBWOOFER PAIRING



i10

**10" SUBWOOFER: i10**  
Dimensions (WxHxD): 14" x 16" x 14"

SONANCE

OUTDOOR

AUDIO

# LANDSCAPES, MEET SOUNDSCAPES

Sonance moves its award-winning audio philosophy of even, balanced coverage outdoors, with a range of all-weather products that are designed to deliver best-in-class performance and best-looking aesthetics in every exterior environment. From courtyards and patios to entire residential estates and resort gardens, Sonance is the undisputed leader in high fidelity sound for the great outdoors.

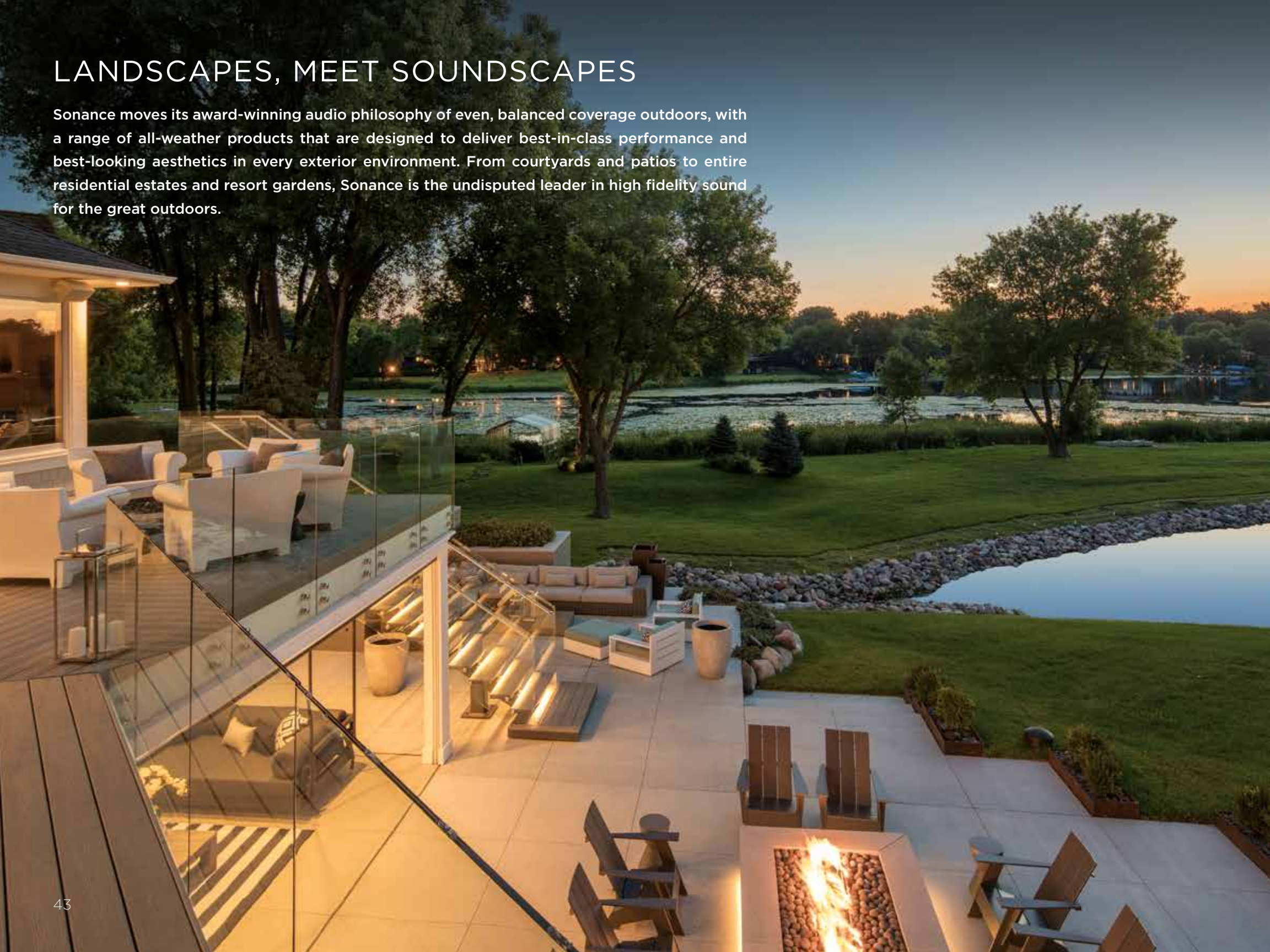

## TRADITIONAL SPEAKER PLACEMENT

In typical outdoor audio installations a pair of speakers is usually tasked with filling an entire yard resulting in music that is either so loud that it becomes uncomfortable or so soft that it is un-engaging.

## UNEVEN VOLUME

Speaker placement in one location creates very loud areas near those speakers and little to no sound further away. This can impact furniture arrangements and natural gathering areas.

## UNBALANCED COVERAGE

It is easy to move in and out of the left and right channels and miss discrete information in the audio.

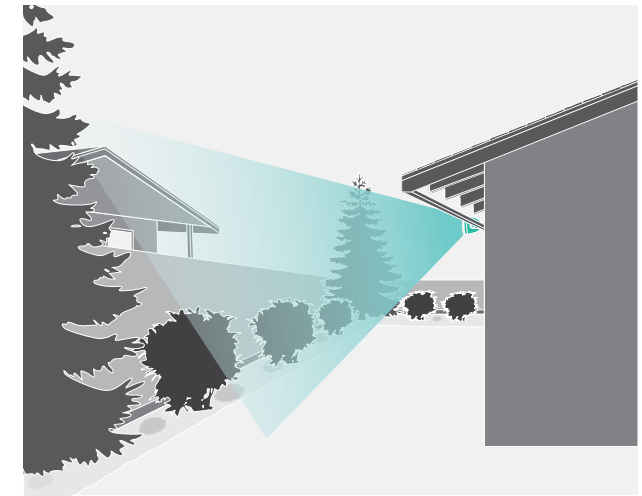
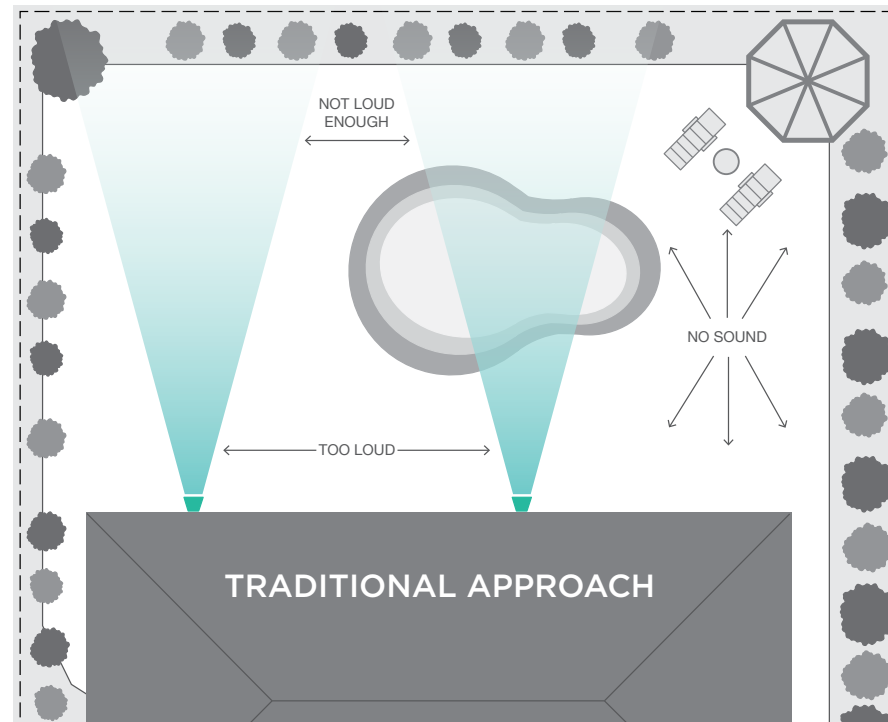

## UNWANTED NOISE

Audio can spill over to neighboring properties creating unwanted disturbances.

## THE SYSTEM APPROACH

Designing a system composed of satellite speakers, subwoofers, amplifiers and DSP technology helps envelop a space fully in clear and balanced audio.

## EVEN VOLUME

This approach is similar to a well layered lighting design that has no hot spots or dark spots, but rather provides smooth even coverage throughout the area.

## EVEN, BALANCED COVERAGE

With satellite speakers and buried subwoofers strategically arranged around the perimeter of the property, audio is able to cover the area from all angles and comfortably immerse the audience.

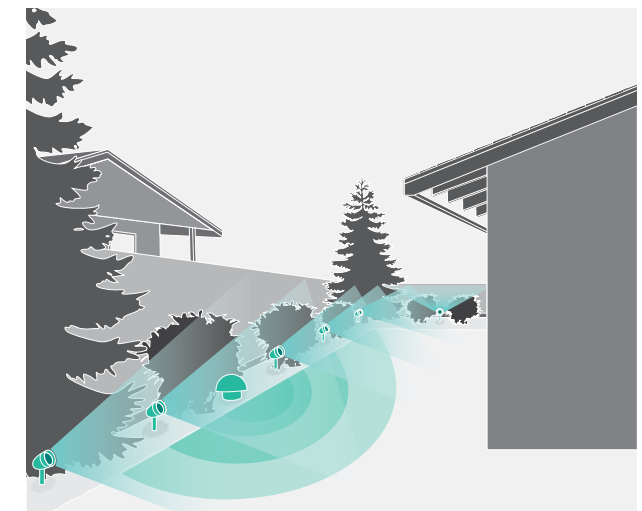

## NO DISTURBANCES

By positioning the system's speakers and subwoofers toward the listening area, no sound is projected out to the neighbors.

# SONANCE LANDSCAPE SERIES



## SATELLITE SPEAKERS

Sonance Landscape Series satellite speakers are selectable for 70V/100V or 8 Ohm configuration and are designed borrowing performance features proven successful by other Sonance products. With new larger Klippel distortion treated drivers as seen in VP Extreme and the same Sonance Laminated Core Transformer as Sonance Professional Series products, SLS satellite speakers provide smooth, effortless bass and clear and natural treble.



## SMOOTH AND POWERFUL BASS RESPONSE

Sonance Landscape Series subwoofers are available in 12" and 15" in-ground or 12" hardscape solutions and are also 70V/100V or 8 Ohm configurable. With a laminar flow port supporting the in-ground subs and the Sonance Laminated Core Transformer featured in all three subs, Sonance Landscape Series subwoofers present the perfect punch for outdoor environments, filling the space with depth and detail.



## SATELLITES



LS6T SAT

LS6T SAT SPEAKER  
Dimensions (Dia): 6 1/2"



LS4T SAT

LS4T SAT SPEAKER  
Dimensions (Dia): 4 1/2"

## SUBWOOFERS



LS15T SUB



LS12T SUB



HS12T SUB

LS15T SUB  
Overall Dimensions (WxH): 21 1/4" x 33 1/2"

LS12T SUB  
Overall Dimensions (WxH): 17" x 29 1/8"

HS12T SUB  
Dimensions (WxHxD): 16 1/8" x 16 1/8" x 16 1/8"

A modern, multi-level house built into a rocky hillside. The house features large glass windows and balconies. In front of the house is a swimming pool. The landscape is rocky with some greenery and a black metal fence in the foreground.

## SONANCE LANDSCAPE SERIES IS FULLY SCALABLE AND EXPANDABLE

Sonance Landscape Series is the award-winning, industry reference in outdoor audio. SLS speakers and subwoofers are a fully scalable premium outdoor audio system that delivers perfectly even coverage and unbelievable sound quality throughout any space, small or large. Capable of impeccable fidelity at any volume and powerful output while hidden among landscape elements, SLS continues the Sonance standard of performance and design working in harmony to deliver an exceptional experience in any outdoor environment.





## WEATHER THE ELEMENTS

Sonance Landscape Series speakers and subwoofers are designed to operate under the most extreme weather conditions, from -20 to 190 F. Triple sealed enclosures, waterproof connectors and marine grade components ensure SLS will stand up to the harshest elements including surf, sun, sand and snow.



RAIN



SNOW



SUN



WIND



SEA



SAND



## FLEXIBLE INSTALLATION

SLS speakers feature versatile mounting hardware options, allowing them to be positioned strategically to create the optimal sound experience.



## ACCESSORIES



19" Ground Stake



9" Ground Stake



Surface Mount



Tree Mount

# SONANCE GARDEN SERIES

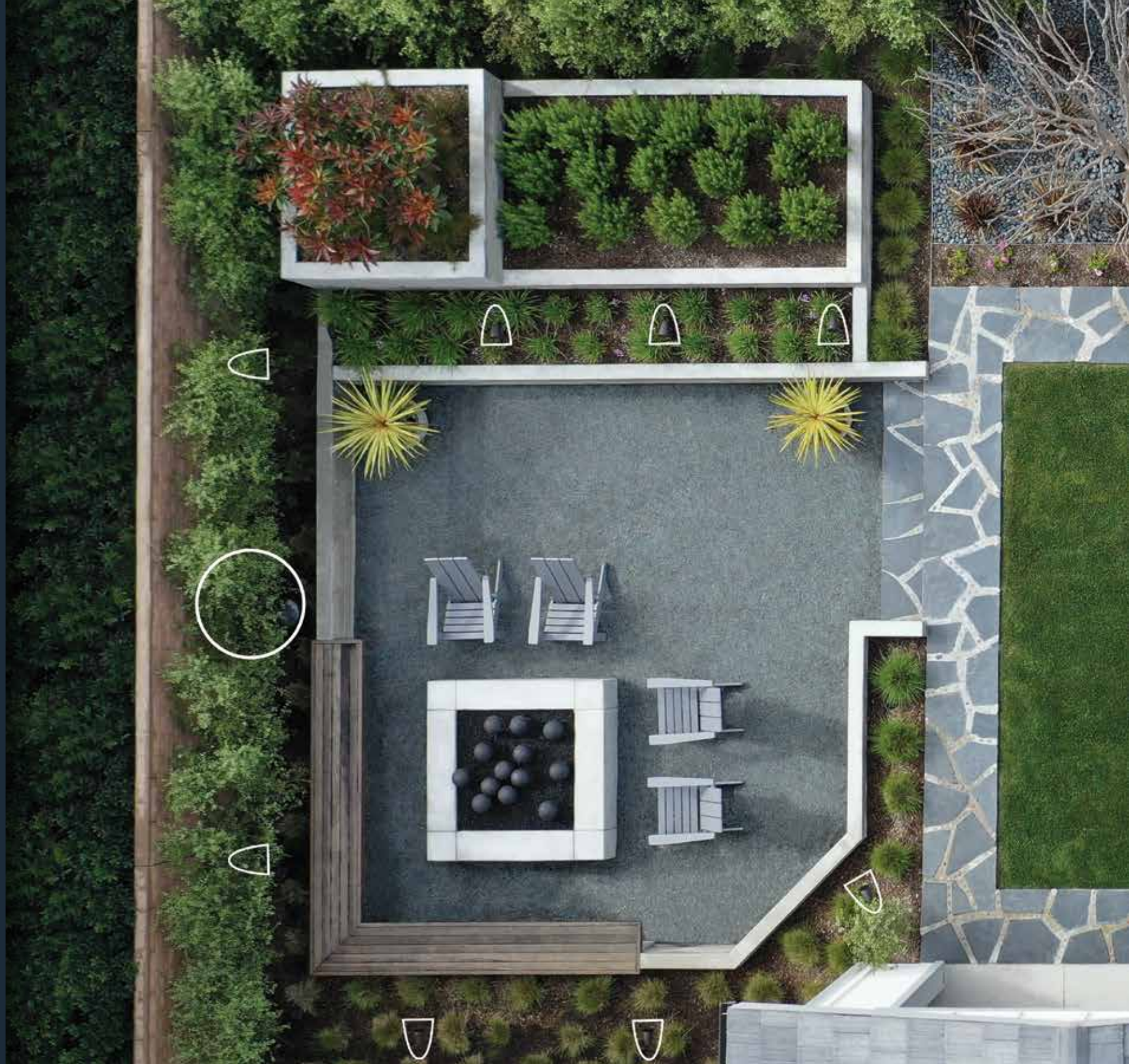

An aerial photograph of a garden. A large, vibrant green lawn occupies the left and center. A winding path made of grey stones with white mortar runs along the right and top edges of the lawn. The path is bordered by a variety of plants, including small pink flowers, green shrubs, and some bare trees. The overall scene is well-maintained and aesthetically pleasing.

## PERFORMANCE AND SIMPLICITY

Sonance Garden Series strikes the perfect blend between performance and affordability and is positioned between the award-winning excellence of Sonance Landscape Series and the system simplicity of SONARRAY.

# SONANCE GARDEN SERIES

## FEATURES AND FLEXIBILITY

Featuring a 3.5" anodized aluminum woofer and a 3/4" polyurethane dome tweeter, the Sonance Garden Series two-way satellite design brings surprising detail to outdoor spaces. The replaceable grille makes servicing the system a breeze and the adjustable speaker knuckle allows the SGS SAT to be precisely positioned for great coverage. The system installation is flexible with multiple available installation options, from the included 1/2" NPS ground stakes to the optional surface mount or tree mount accessories.

The 10" dual voice coil, in-ground subwoofer provides amazing bass to complete the outdoor music experience. Taking advantage of our latest laminar flow port design, the SGS SUB delivers smooth bass that's ready for the elements. The high-density polyethylene enclosure is fully sealed and non-corroding, ensuring years of enjoyment.

## WEATHER THE ELEMENTS

The Sonance Garden Series speakers and subwoofers are designed to operate under the most extreme weather conditions, from -20 to 190 F. Triple sealed enclosures, waterproof connectors and marine grade components ensure SGS will stand up to the harshest elements including surf, sun, sand and snow.



RAIN



SNOW

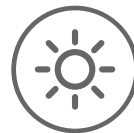

SUN



WIND



SEA



SAND



## SGS 8.1 SYSTEM

Sonance Garden Series is flexible for system design from a single four conductor wire. Our DSP Amplifiers will support speaker layouts of 8.1/8.2, 12.1/12.2 up to 16.1/16.2 configurations, helping to set the mood for engaging outdoor music in spaces up to 3,500 sq. ft. Sonance Garden Series can be expanded for up to 16 speakers and two subwoofers on a single amplifier.



SGS 8.1 SYSTEM WITH SR 2-125 DSP AMPLIFIER

## SGS ADD-ON PRODUCTS

### 2-125 AMPLIFIER



SR 2-125 AMPLIFIER

Dimensions with feet (WxHxD): 8 5/8" x 2 1/8" x 16 13/16"

### SGS SAT 4-PACK



SGS SAT 4-PACK

Dimensions with Stake (LxDia.): 16 1/2" x 4 1/2"

### SGS SUB



SGS SUB

Overall Dimensions (LxDia.): 5" x 15"



SONANCE GARDEN SERIES

## SONANCE GARDEN SERIES CONFIGURATIONS

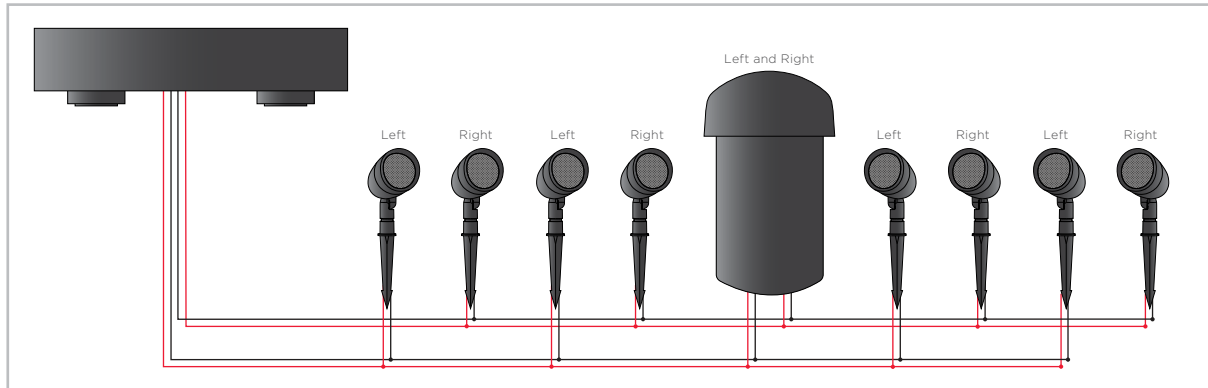

SONANCE GARDEN SERIES 8:1 CONFIGURATION

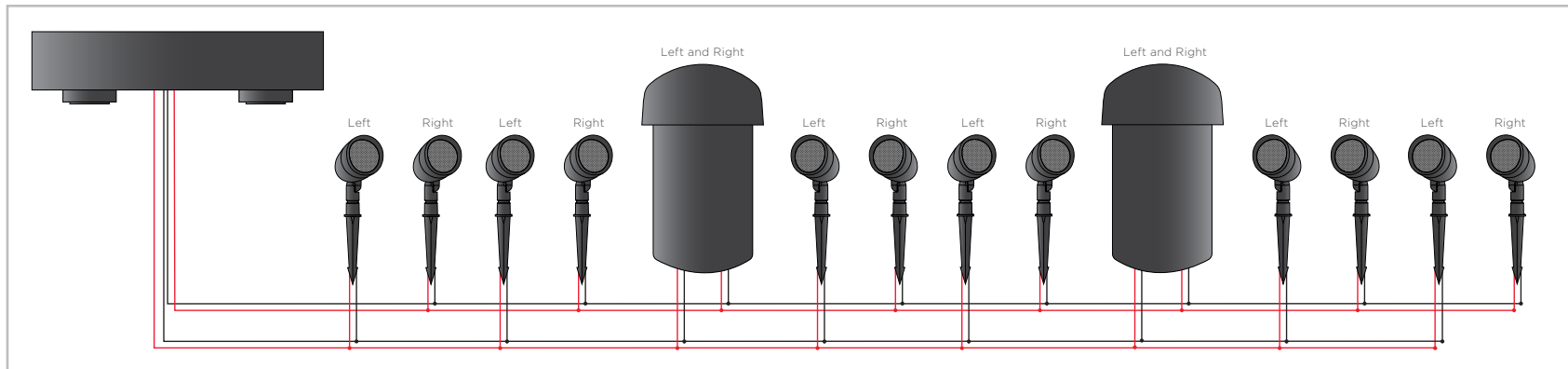

SONANCE GARDEN SERIES 12:2 CONFIGURATION

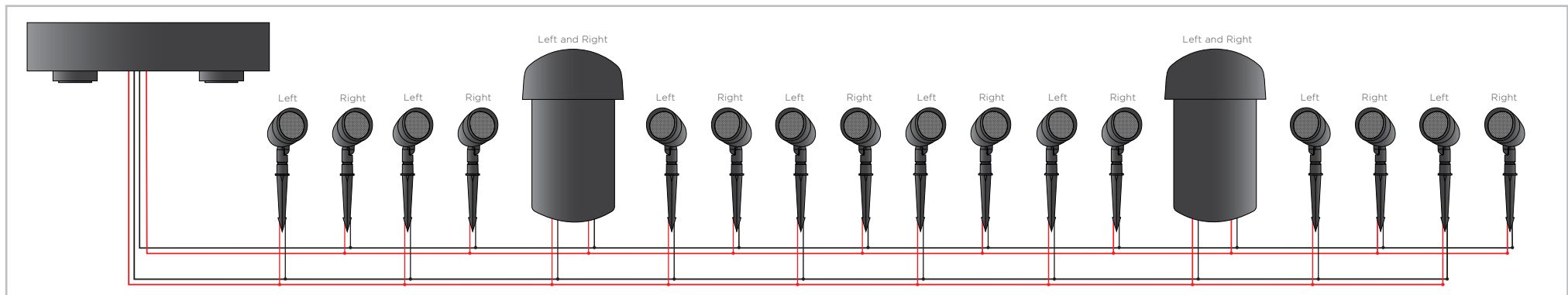

SONANCE GARDEN SERIES 16:2 CONFIGURATION

# SONARRAY

## PERFECT QUALITY, PERFECT COVERAGE

Great in backyards and patios, the SONARRAY system of satellite speakers, subwoofer, and SR 2-125 amplifier creates crystal clear audio, raising the bar for affordable outdoor audio.





## SATELLITE SPEAKERS

SONARRAY SR1 includes eight satellite speakers with full-range drivers to deliver crystal clear sound. By positioning the speakers around the perimeter of the entertaining area, facing inwards, the space is enveloped in beautiful sound at the perfect volume, without loud zones or dead spots.

## SUBWOOFER

SONARRAY features an 8" dual voice coil, buried subwoofer, which delivers incredibly smooth bass. The SR1's subwoofer radiates sound throughout the same area as the eight satellite speakers, pairing even bass with breathtaking fidelity and clarity.

## BRING IT ALL TOGETHER

The SONARRAY system is completed with a Sonance SR 2-125 amplifier. With presets designed specifically for SONARRAY and tested for any environment, the SR 2-125 perfectly tunes and balances the SONARRAY system. A single SR 2-125 amplifier will support a standard system of eight speakers and one subwoofer or can power an expanded system of up to 16 speakers and two subwoofers for greater area coverage.

## SONARRAY SR1 SYSTEM



SONARRAY SR1 System with SR 2-125 Amplifier

SONARRAY SR1 System without Amplifier

## SONARRAY ADD-ON PRODUCTS

### SR 2-125 AMPLIFIER



SR 2-125

Dimensions with feet (WxHxD): 8 5/8" x 2 1/8" x 16 13/16"

### SONARRAY SR1 SAT 4-PACK



SR1 SAT 4-PACK

Overall Dimensions (LxDia.): 6 1/2" x 4 1/8"

### SONARRAY SR1 SUB



SR1SUB

Overall Dimensions (LxDia.): 22" x 15"

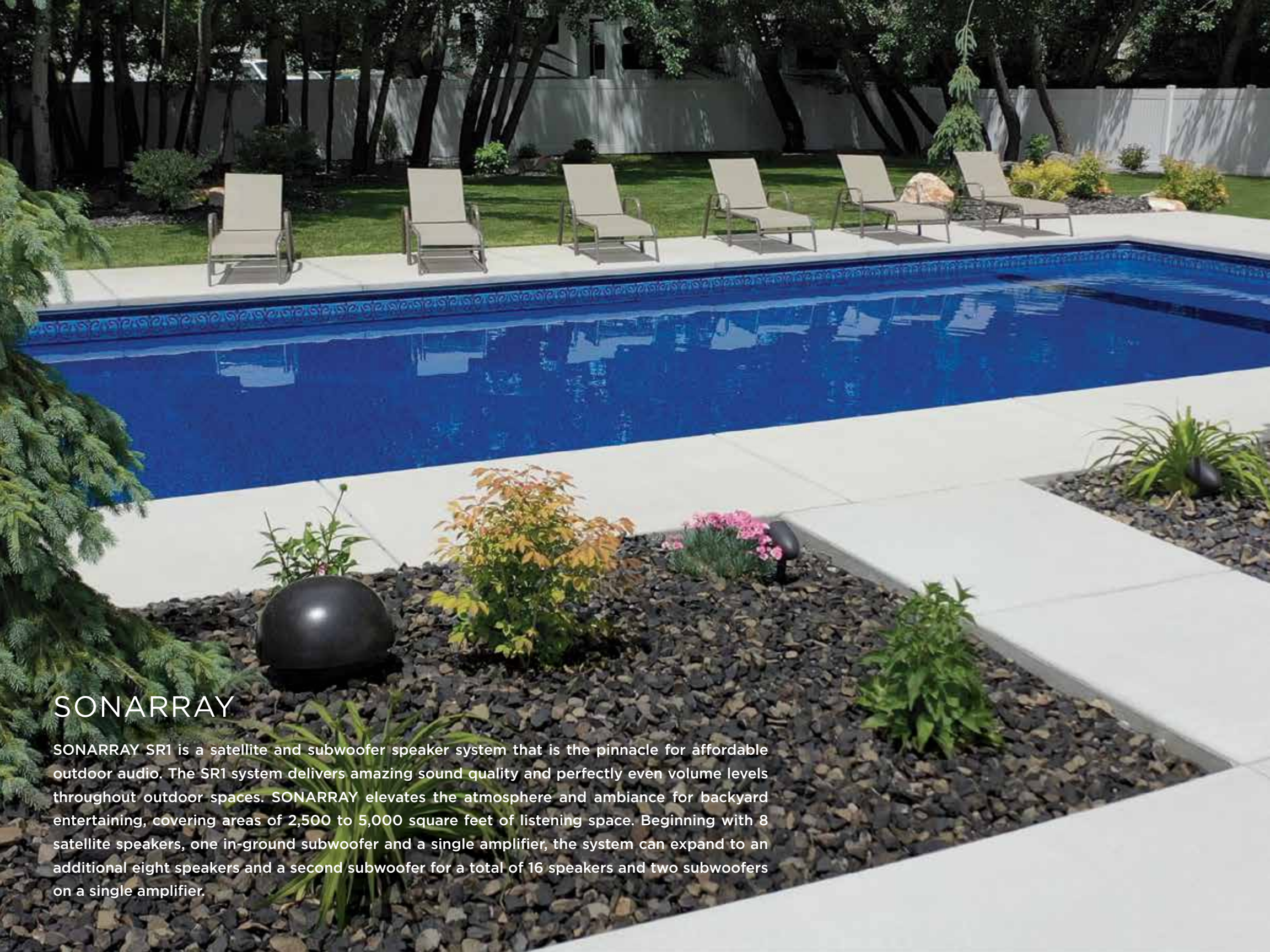

## SONARRAY

SONARRAY SR1 is a satellite and subwoofer speaker system that is the pinnacle for affordable outdoor audio. The SR1 system delivers amazing sound quality and perfectly even volume levels throughout outdoor spaces. SONARRAY elevates the atmosphere and ambiance for backyard entertaining, covering areas of 2,500 to 5,000 square feet of listening space. Beginning with 8 satellite speakers, one in-ground subwoofer and a single amplifier, the system can expand to an additional eight speakers and a second subwoofer for a total of 16 speakers and two subwoofers on a single amplifier.

# SONARRAY CONFIGURATIONS

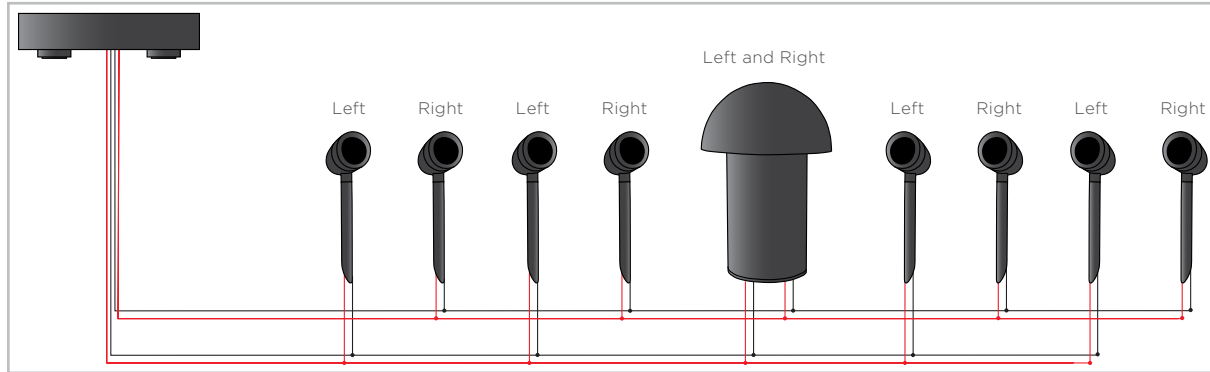

SONARRAY 8:1 CONFIGURATION

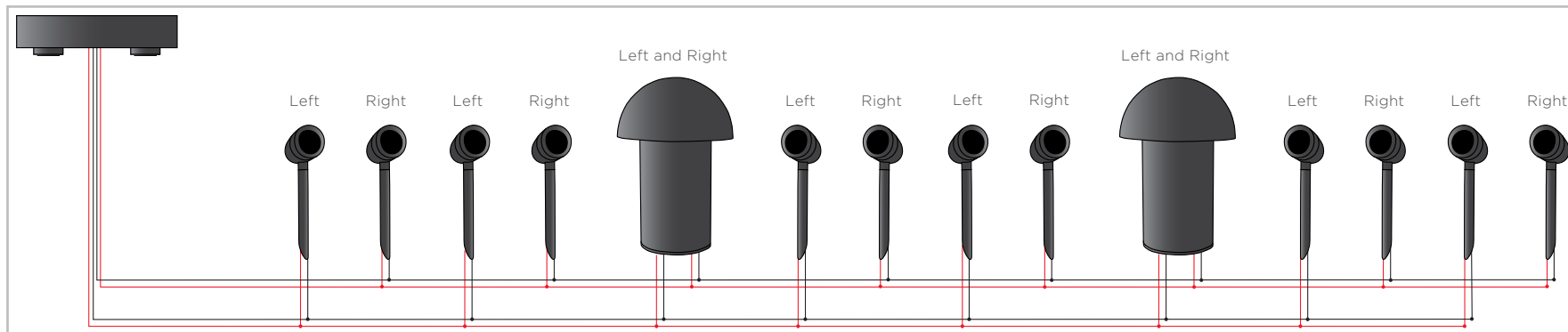

SONARRAY 12:2 CONFIGURATION

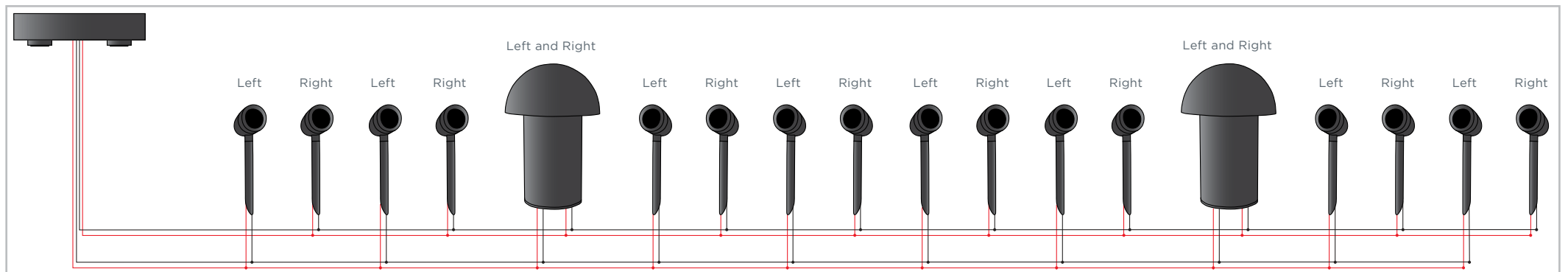

SONARRAY 16:2 CONFIGURATION

# VP EXTREME

## VP EXTREME

Visual Performance Extreme carries the design success of Sonance Visual Performance speakers delivered in a highly enduring construction for extreme elements making them perfect for marine environments, patios, saunas, and spas.



## EXTREME POST CAPTURE

With extreme circumstances in mind, Sonance developed Extreme Post Capture grille retention technology (XPC) to securely grip each Extreme grille to its speaker. This protects the grilles from harsh encounters with wind and high pressure washing. Extreme square grille adapters and grilles seamlessly transform any Extreme round speaker into a square finish without the need for additional cutting. Also featuring Sonance XPC technology, square grilles will remain intact when presented with intense wind or water.



## SQUARE ADAPTERS

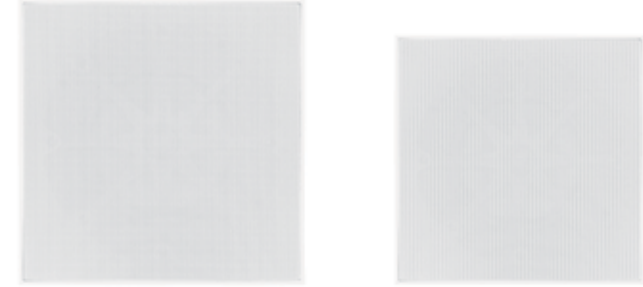

VPXT8SQ

Dimensions (WxH): 11" x 11"

VPXT6SQ

Dimensions (WxH): 9 7/8" x 9 7/8"

## IN-WALL SPEAKER



VPXT6

VPXT6 SPEAKER

Dimensions (WxHxD): 8 3/8" x 12 1/4" x 2 1/2"

## IN-CEILING SPEAKERS



VPXT8R

SPEAKER: VPXT8R

Dimensions (DiaxD): 11 5/8" x 3 3/4"



VPXT6R

SPEAKERS: VPXT6R | VPXT6R SST

Dimensions (DiaxD): 9 3/4" x 3 1/2"



VPXT6R SST

# MARINERS & ROCKS

## PERFORMANCE

Sonance has a range of high-performance outdoor speakers for any traditional installation. Rock speakers and subwoofers in natural colors and textures are designed to hide in garden beds. Mariner speakers are perfect for courtyards, patios, and yachts.

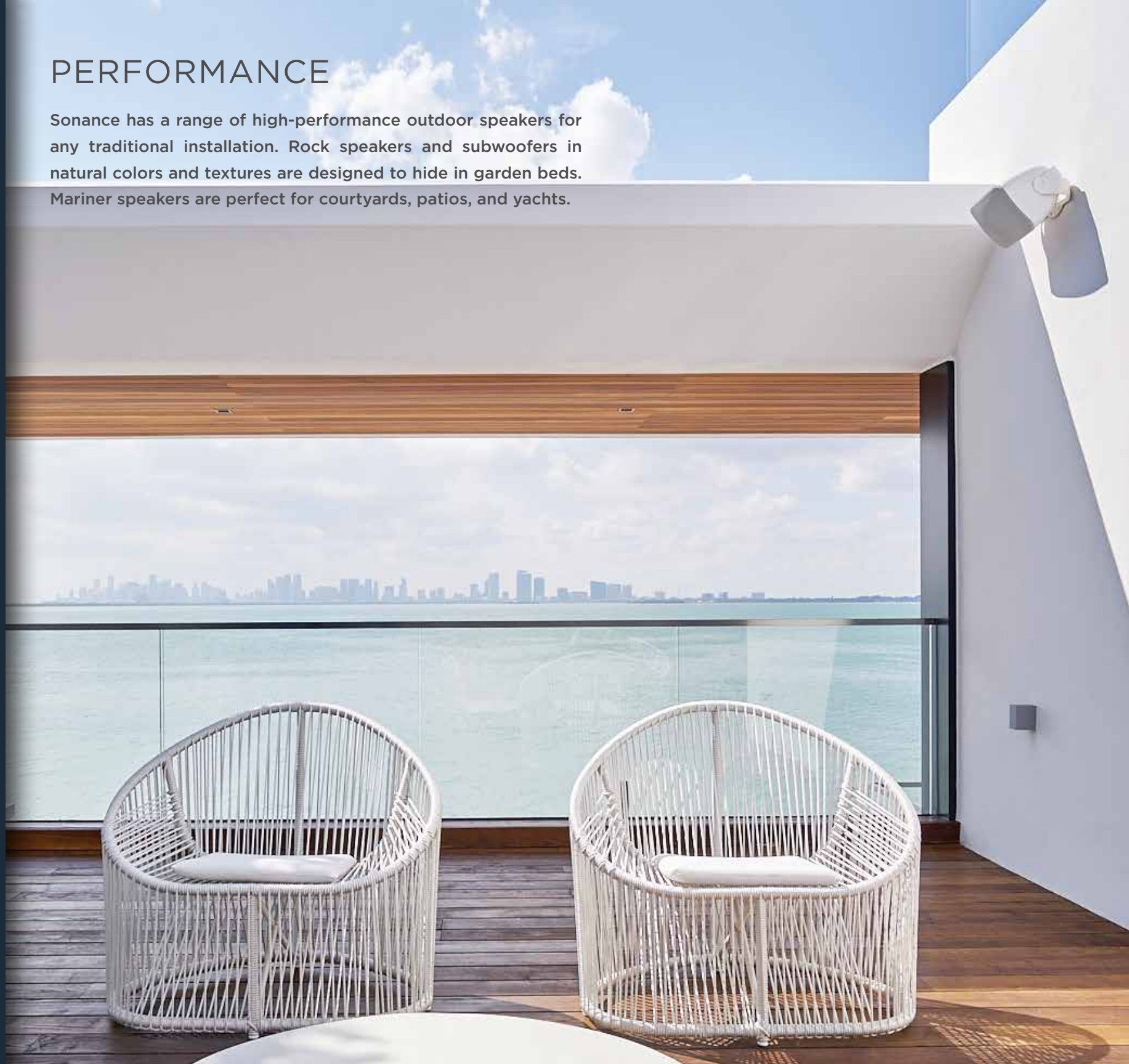



## MARINERS

Sonance Mariner speakers feature an innovative front-mounted terminal connection that not only makes wiring easier, it safeguards the speaker terminals against moisture and the elements. Mariner speakers feature an exclusive Fastmount® bracket system that enables simple push and lock to fasten each speaker into place—no threaded knobs or extra hardware necessary. Once mounted, the speaker can be easily pivoted to direct the sound where you want it, and they will stay where you position them without drooping or slipping over time. Finished with a perfect fit trimless grille engineered to remain securely in place, Mariner speakers will contribute a sleek and clean look to any outdoor space.



## ROCKS

Sonance rock speakers utilize a durable weather-resistant construction that is built to withstand the harshest outdoor environments. Featuring waterproof drivers, the Sonance RK63 and RK83 deliver clean articulate sound while standing up to the elements. For those wanting even more impressive sound outdoors, the optional RK10W subwoofer features the same durable construction with a 10" polypropylene cone woofer for added bass response.

## MARINERS

Available in black and white



Mariner 54



Mariner 54 SST



Mariner 56



Mariner 64



Mariner 64 SST



Mariner 66



Mariner 86

**SMALL SPEAKERS: MARINER 54 | MARINER 54 SST | MARINER 56**

Dimensions (WxHxD): 6 3/8" x 10" x 5 3/4"

**MEDIUM SPEAKERS: MARINER 64 | MARINER 64 SST | MARINER 66**

Dimensions (WxHxD): 7 1/2" x 12 1/4" x 6 3/4"

**LARGE SPEAKERS: MARINER 86**

Dimensions (WxHxD): 9" x 14" x 8 1/2"

## ROCKS

Available in brown and granite



RK63



RK83

**SMALL SPEAKER: RK63**

Dimensions (WxHxD): 13 3/4" x 11" x 11"

**LARGE SPEAKER: RK83**

Dimensions (WxHxD): 17 1/4" x 12 1/2" x 14"

## ROCK SUBWOOFER

Available in brown and granite



RK10W Woofer

**WOOFER: RK10W**

Dimensions (WxHxD): 19 3/8" x 16 7/8" x 14 3/8"

SONANCE  
COMMERCIAL  
SOLUTIONS





## COMMERCIAL SOLUTIONS

Sonance has been regarded as an industry leader for decades. When the industry demanded superior performance and premium aesthetics from commercial products, Sonance heard the call to action to revolutionize the market. With solutions spanning many applications and the introduction of Sonance Professional Series dedicated to the commercial scene, Sonance is able to empower the commercial integrator with the tools to cover any space.



### INVISIBLE SERIES

Sonance offers a completely invisible solution intended for commercial applications requiring ultimate elegance. The IS4 C is specified exclusively in many retail spaces for luxury boutique brands throughout the world. Its use of the Sonance Laminated Core Transformer for 70V/100V flexibility makes it a powerful and desirable option for the demands of commercial spaces.



### IPOINT

IPOINT by Sonance offers elegant solutions for the home and business. Transforming the way dedicated use tablets are incorporated into the workplace, IPOINT continues to redefine where and how businesses use tablets in applications like hotel rooms, corporate offices, yachts, and fleet vehicles. IPOINT products solve real business problems and enhance the usability of tablets.



### SONANCE LANDSCAPE SERIES

With the Sonance Laminated Core Transformer for 70V/100V or 8 Ohm configurations, SLS can seamlessly transition music for commercial spaces from indoors to outdoors. SLS is widely used in amusement parks, wineries, hotels, resort gardens, and golf courses around the globe.



### SONANCE 70V DSP AMPLIFIERS

Sonance 70V DSP Amplifiers are a powerful way to complete any commercial audio system. With Sonance DSP curves to satisfy adjustments and tuning for speaker placement and atmosphere, Sonance amplifiers perfectly optimize any commercial system.

# PROFESSIONAL SERIES

## PERFORMANCE

Sonance Professional Series products are changing the commercial audio scene. Each speaker is equipped with class-leading sensitivity & sonic performance and an exceptional off-axis response. The product family also features consistent voicing across the range and a full-fidelity transformer for uncompromising tonality. In response to industry demand, each product also comes ready to easily install with uncomplicated hardware included in the box.



## IN-CEILING

- UL 1480 & UL 2043 Certified
- Two-Way Pivoting Tweeter
- Finger-Adjustable Tap Switch
- Integrated Backcan
- One-Piece Magnetic Paintable Grille
- Optional Black Grille
- Optional Square Adapter in Black or White Grille Options

## SURFACE MOUNT

- UL 1480, IPX4, MIL SPEC810, & UV IEC 529 Certified
- Powder Coated Aluminum Grille
- Black or White Paintable Options
- Front-Mounted Tap Switch
- Front-Mounted Connector with Cover
- FastMount® Bracket System

## PENDANT

- UL 1480 & UL 2239 Certified
- Two-Way Pivoting Tweeter
- One-Piece Magnetic Grille
- Black or White Paintable Options
- Front-Mounted Tap Switch
- Hanger and Connector Cover
- Ships with Gripple Mounting Kit

## SUBWOOFER

- 70V/100V with 8 Ohm Bypass
- Movable Port for Orientation
- Optional Low-Profile Bracket
- Fly-Points for Suspension Mounting
- Under-Seat Mounting
- Cable Strain Relief

## IN-CEILING

Available in black or white grille



### PS-C43RT

Dimensions (DiaxD): 6 3/10" x 7"

### PS-C63RT

Dimensions (DiaxD): 9 1/8" x 8 7/8"

### PS-C83RT | PS-C83RWT

Dimensions (DiaxD): 11 1/16" x 9 7/8"

### PS-C43RTLTP

Dimensions (DiaxD): 9 4/32" x 3 1/2"

### PS-C63RTLTP

Dimensions (DiaxD): 11 1/16" x 4 1/3"

## PENDANT

Available in black and white



### PS-P43T

Dimensions (DiaxH): 6 1/3" x 11"

### PS-P63T

Dimensions (DiaxH): 9 4/32" x 15 2/3"

### PS-P83T | PS-P83WT

Dimensions (DiaxH): 11 1/16" x 19 3/4"

## SURFACE MOUNT

Available in black and white



### PS-S43T

Dimensions (WxHxD): 5 1/2" x 9 1/4" x 4 7/8"

### PS-S53T

Dimensions (WxHxD): 6 1/3" x 10 1/16" x 5 2/3"

### PS-S63T

Dimensions (WxHxD): 7 1/2" x 12 1/8" x 6 7/8"

### PS-S83T | PS-S83WT

Dimensions (WxHxD): 9" x 14" x 8 1/2"

## SUBWOOFER



PS-S210SUBT

### PS-S210SUBT SUBWOOFER

Dimensions (LxWxH): 33" x 14" x 9"

I PORT  
BY SONANCE

At IPORT, we believe in enhancing the utility of a dedicated-use tablet at home and at work by combining design, technology, and function so that you can experience iPad® in a whole new way.

**HOLD. CHARGE. PROTECT. IPAD®**

# IPOWER



RESIDENTIAL



HOSPITALITY



CORPORATE



FOOD & BEVERAGE



FLEET



## HOLD. CHARGE. PROTECT.

iPad has become the go-to device to control the app-driven connected home. We believe that by creating ways to hold, charge and protect it, iPad transforms into an epic dedicated controller. Whether on the wall in fixed locations or free-floating throughout the home, IPORT offers a range of charging and mounting systems that add much-needed accessibility to iPad in home control applications.

It gets even better with optional hard buttons embedded in our enclosures that provide instant shortcuts to scenes and key functions for nearly any control system. Say hello to the IPORT family of products: enhancing the user experience of the app-driven connected home.





### IPORT LUXE

The premium wireless charging and mounting system for iPad designed for charging on table-top or on-wall. Available in silver, black and white.



Case



BaseStation



WallStation



Wall Adapter Kit

#### LUXE CASES

iPad mini 4, 5th gen  
 iPad, 5th & 6th gen  
 iPad Pro 10.5", iPad Air 10.5", 3rd gen

#### LUXE CHARGING STATIONS

WallStation  
 BaseStation

#### LUXE ACCESSORIES

Wall Adapter Kit



### IPORT LAUNCH

A wireless charging system for iPad designed to hold, charge and protect iPad on a table, wall or in a vehicle. Available in silver, black and white.



Case



BaseStation



WallStation

#### LAUNCH SLEEVES

iPad mini 4, 5th gen  
 iPad 5th & 6th gen

#### LAUNCH CHARGING STATIONS

Launch WallStation  
 Launch BaseStation



### IPORT SURFACE MOUNT

The most elegant way to mount iPad on a wall or solid surface. Available in black and white.



Surface Mount



Surface Mount with Buttons



#### SURFACE MOUNT SYSTEM

iPad mini 4, 5th gen  
 iPad 5th & 6th gen  
 iPad Air 10.5", 3rd gen  
 iPad Pro 12.9", 1st & 2nd gen

#### SURFACE MOUNT 6 BUTTONS SYSTEM

iPad mini 4, 5th gen  
 iPad 5th & 6th gen  
 iPad Pro 12.9", 1st & 2nd gen

#### SURFACE MOUNT 10 BUTTONS SYSTEM

iPad mini 4, 5th gen  
 iPad 5th & 6th gen  
 iPad Pro 12.9", 1st & 2nd gen



### xPRESS

The Audio Keypad for Sonos®, allows you to control your Sonos® device anywhere, anytime. Play music, adjust volume, skip tracks, and assign favorites with the press of a button.



xPRESS  
 Audio Keypad

#### xPRESS AUDIO KEYPAD

xPRESS